



ERGO LINE (GN 1/1)

Duo - Cooling Compressor - Heating Fan

- ✓ **Two Boxes in Side-By-Side Configuration**
- ✓ **Superb Insulation Values**
- ✓ **Outstanding Manouverability**



ScanBox Ergo Line - Duo - Cooling Compressor - Heating Fan is a range of products suited perfectly for any commercial kitchen operation requiring hot and cold holding or transport capacity. Designed with two fully seperated box compartments in a side by side configuration. Intuitive controls, ergonomic design and a wide range of different sizes and accessories will gurantee a perfect match with your operation. Designed with ScanBox latest Environmental Performance (ExP) technology combining increased performance with a decreased environmental impact. Designed to fit equally well back of house as well as front of house allowing exterior branding options.

Function

Two boxes positioned side by side, equipped with a powerful compressor cooling system and fan heating. Both systems located on the back of the unit. The fan heating system offers fast and uniform temperatures and also has a adjustable moisture ventilation while the compressor cooling system provides quiet and reliable cooling.

Standard Equipment	Options
Backmounted Heating	International Plugs
Rearmounted Compressor	
S/S Heater	
Adjustable Temperature	
Adjustable Moisture Vent	
European Plug Type	

Capacity

Equipped with detachable stainless steel racks allowing the air to circulate freely inside the cavity. The u-shaped racks has a tilt-stop function securing the foodcontainer and lid during loading, unloading and transport. Variety of sizes and rack configurations allowing optimal usage of the box.

Standard Equipment	Options
GN 1/1 80 mm distance	Optional level distance
Detachable Racks	
Tilt-Stop Function	

Mobility

Lightweight, yet heavy duty. A solid design made for all types transports including truck. Equipped with non-marking, high quality double bearing castors for easy manouverability even in cramped spaces. Precision moulded PPE insulation assures food temperature and safety when the box is not plugged into power.

Standard Equipment	Options
Ø160 mm Castors	Optional Sized Castors
Double Bearing Castors	Stainless Steel Castors
Transport Handles *5	Tow Bars

Ease of Use

Equipped with an intuitive and easy to use display conviniently positioned in front top of unit. All-around top frame allows easy handling facing the unit from any direction. The 4,5 meter long single phase spiral cord is positioned on the back of the unit.

Standard Equipment	Options
One Grip Handle	Sight window/Glass door
Extra Long Spiral Cord	Tray holder foldable
Digital Controller in Front	
Central brake system	

Construction

A heavy duty yet lightweight construction based on a stainless steel framing, reinforced plastic exterior panels, solid high precision moulded polyurethane foam insulation and anozined aluminium interior. A smooth, hygienic and fully sealed inner cavity without welds or rivets. The frame, top hood and handles are in robust stainless steel.

Standard Equipment	Options
Smooth Hygienic Cavity	
Smooth S/S Top	
S/S Framing	

Exterior Design

Robust and elegant Scandinavian design made for both back of house as well as front of house operations. Possibility to choose different colours as well as adapting parts or the full box according to corporate branding. Use the design and let the box be a part of the full F&B experience.

Standard Equipment	Options
Black Glossy Finish	Optional colors
Black (RAL 9005)	Signature concept

Product Safety

High quality product Made in Sweden with high level of engineering details to performance, safety and easy of use. Thorough quality and safety testing through external third party. CE marked with complimentary EMC, RoHS, REACH and electrical safety testing.





Technical Specification

Model Series



ERGO LINE - Duo - Cooling Compressor - Heating Fan

Product Models	CC08 + HF08	CC12 + HF12	CC14 + HF14
Article Number	ELDCF08	ELDCF12	ELDCF14
Active Cooling & Heating			
Controller	Digital adjustable	Digital adjustable	Digital adjustable
Heat Source	Electric Element	Electric Element	Electric Element
Cooling Source	Compressor	Compressor	Compressor
Heating - Temperature Range	Ambient up to 90°C	Ambient up to 90°C	Ambient up to 90°C
Cooling - Temperature Range	Between +20°C - +3°C	Between +20°C - +3°C	Between +20°C - +3°C
Cooling - Refrigerant	R134a	R134a	R134a
Cooling - Charge	110	110	110
Cooling - Climate Class *4	4	4	4
Heating Time *1	25 min	25 min	25 min
Cooling time *1	35 min	35 min	35 min
Heating - Energy consumption to operating temp *2	0,25 / 0,25 kWh	0,30 / 0,30 kWh	0,30 / 0,30 kWh
Cooling - Energy consumption to operating temp *2	0,10 / 0,10 kWh	0,10 / 0,10 kWh	0,10 / 0,10 kWh
Capacity			
Standard	GN 1/1	GN 1/1	GN 1/1
Pitch between levels	80 mm	80 mm	80 mm
Number of 65 mm containers	8	12	14
Number of 100 mm containers	5	8	9
Number of 150 mm containers	3	5	6
Maximum load per rack	9 kg	9 kg	9 kg
Maximum load in unit	72 + 72 kg	108 + 108 kg	126 + 126 kg
Max total weight (full unit)	240 kg	340 kg	380 kg
Physical Attributes			
External dimensions (W x H x D) mm	1100 x 1065 x 870	1100 x 1385 x 870	1100 x 1545 x 870
Internal dimensions (W x H x D) mm	352 x 727 x 600	352 x 1047 x 600	352 x 1207 x 600
Volume	154 + 154 Liter	221 + 221 Liter	255 + 255 Liter
Net weight (empty unit)	110 kg	125 kg	135 kg
Door opening	270°	270°	270°
Length of Powercable	4,5 m	4,5 m	4,5 m
Electrical Attributes			
Rated Voltage	220-240V / 1 phase	220-240V / 1 phase	220-240V / 1 phase
Rated Frequency	50-60 Hz	50-60 Hz	50-60 Hz
Rated Current	4,24 A Total	5,55 A Total	5,55 A Total
Power rating	130 / 700 W	130 / 1000 W	130 / 1000 W
IP Code *3	22	22	22

Dimension drawings

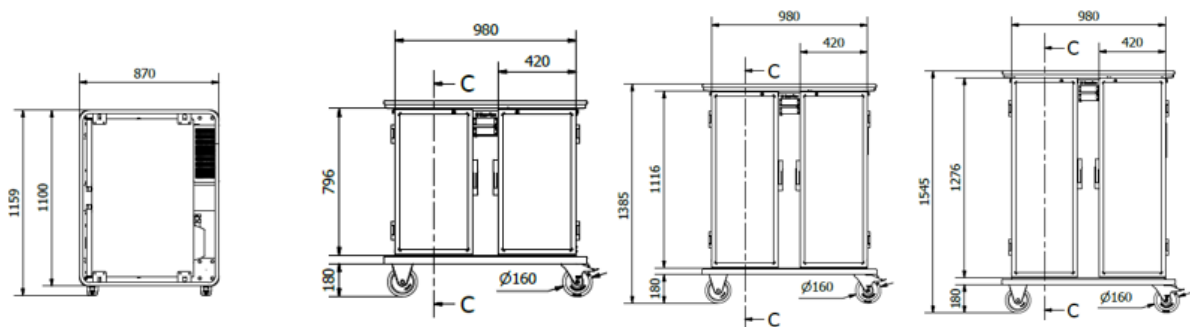

*1 - Time for a hot unit to reach 80 ° C and for a cold unit to reach 5 ° C average temperature in the air in the cavity with 22 ° C ambient temperature.

*2 - Operating temperature in hot unit of 80 ° C and in cold unit of 5 ° C with 22 ° C ambient temperature.

*3 - IP22 = Protection against penetration of solid objects larger than 12,5 mm and protected against falling drops of water (IEC 60529)

*4 - Climate class 4 means that the unit is designed for use in ambient temperatures of up to 30 ° C.

*5 - Recessed handles standard on ELDC12 + ELDC14